

Forcing Connection with Ricoh RDC-2/RDC-2E And Your Computer

- Connect the camera to your PC and start the Ricoh Photo Studio Program.
- Turn your camera off, but leave the monitor on. Go to the “File” menu and “Download Ricoh Files” select RDC-1 as the source and the appropriate COM Port and click “okay”
- Press the “Timer” button while turning on the camera to PC [PLAY] , on the screen of the camera you can see the following menu;

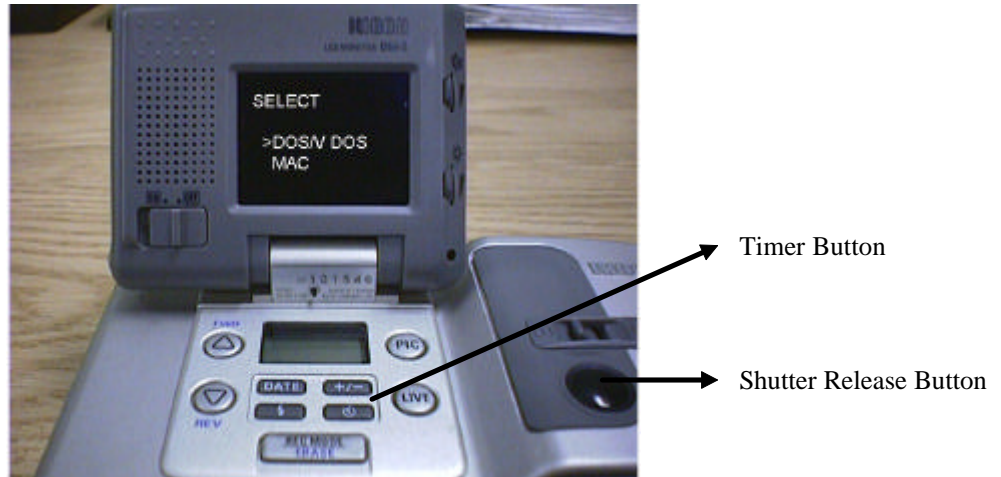

- Select with the “FWD/REV” buttons to “DOS V. DOS” (for PC Computers) or MAC (for Macintosh Computers) and press the shutter release button.
- The next screen on the camera asks you to choose the BAUD rate.



- Select with the “FWD/REV” buttons the BAUD Rate at 19,200 and press the shutter release button.
- Do all of the above in 60 seconds or less after clicking “OKAY” from the “Download Option” Box on the computer.